

由于我们在不断努力改进产品，我们保留样本数据更改的权利，敬请谅解。

As we are constantly endeavouring to improve the performance of our equipment.

The company reserves the right to make alteration from time to time and equipment differ from that detailed in this brochure.

# IS 型单级单吸离心泵

## IS MODEL SINGLE-STAGE SINGLE-SUCTION CENTRIFUGAL PUMP

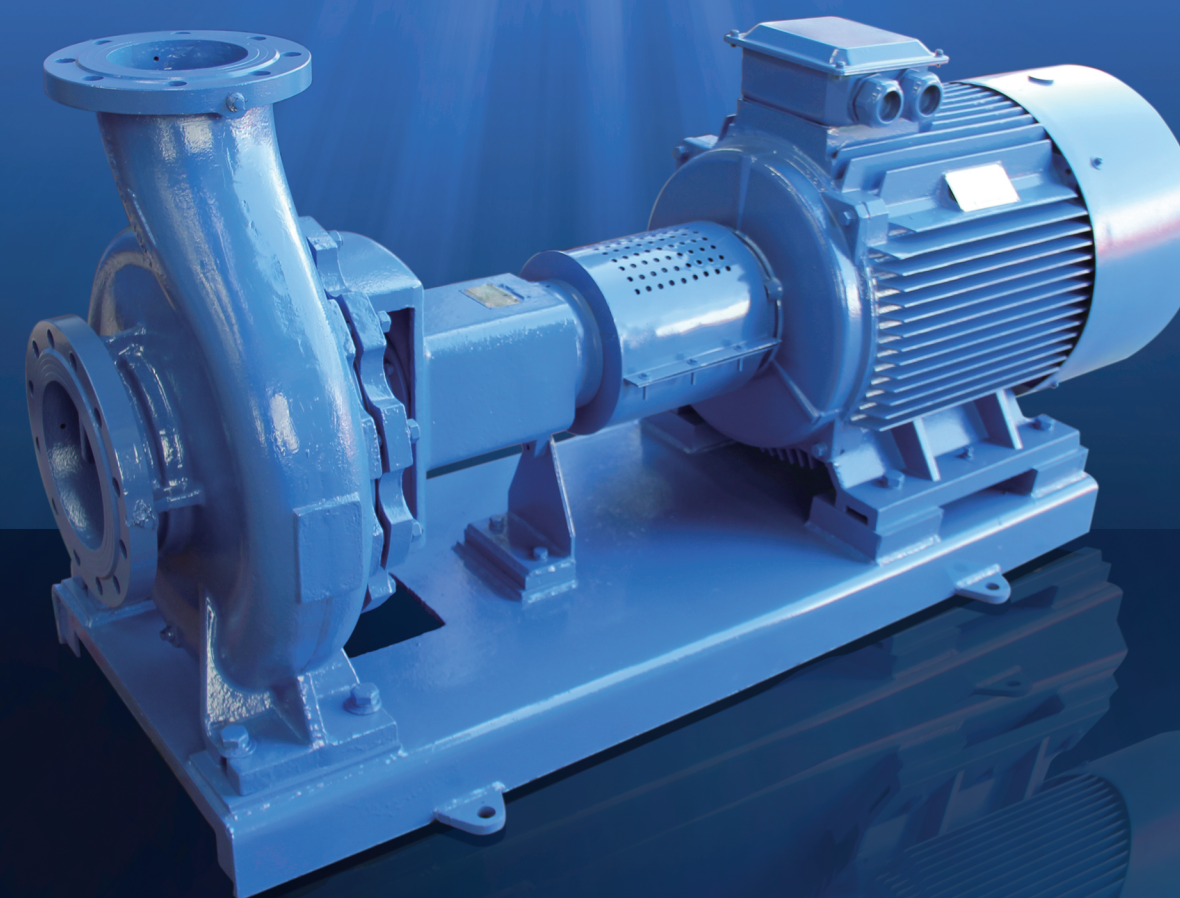

### 上海连成(集团)有限公司

SHANGHAI LIANCHENG (GROUP) CO.,LTD.

地址：上海市江桥曹安公路3616-3618号

邮编：201812

总机：(021) 59138888

传真：(021) 59136782

800免费咨询电话：800-820-5009

400免费咨询电话：400-188-5009

Address:3616-3618 Cao'an Road, Jiangqiao Shanghai

P.C.: 201812

Switchboard: (021) 59138888

Fax: (021) 59136782

800 Free consultation Tel:800-820-5009

400 Free consultation Tel : 400-188-5009

# 目 录

## CONTENTS

<b>产品概述</b> Product overview	1
<b>结构特点</b> Structure characteristics	1
<b>工作条件</b> Working conditions	2
<b>型号意义</b> Model meaning	3
<b>主要用途</b> Main purpose	3
<b>结构说明</b> Structure description	4
<b>型谱图</b> Atlas of style	5
<b>性能参数表</b> Performance table	6
<b>泵头安装尺寸图</b> Size of installation of pump head	17
<b>泵头安装尺寸表</b> Table of installation of pump head	18
<b>外形及安装尺寸图表</b> Out-form and installation dimension drawing, table	19
<b>管路损耗参考表</b> Reference table for pipeline loss	23

## 产品概述 Product overview

新型IS系列单级单吸悬臂式离心泵是本公司严格按照国际标准ISO2858及最新国家标准GB/T5767设计成功的新一代高效节能产品，其性能参数是由原IS型清水离心泵性能参数优化、扩展而成，其内部结构、整体外观是集成原IS型清水离心泵及现有的卧式泵、悬臂式泵的优点设计而成，使其不论性能参数还是内部结构以及整体外观都更趋于合理、可靠。

该系列产品包含了国际标准ISO2858所规定的全部型号产品，并增加了进口口径250以上（包含250口径）型号产品，通过切割叶轮和调整转速可以获得170种型号的产品，能适应各行各业的输水需求。

该系列泵可供输送清水或物理化学性质类似于清水且不含固体颗粒的液体之用。该系列泵可根据实际需要派生设计制造成ISR型热水泵及ISY型油泵；IS型泵适用于介质温度80℃以下，ISR型泵适用于介质温度100℃以下，ISY型泵适用于输送汽油、柴油等轻油。

该系列泵流量范围为3.4~1440m<sup>3</sup>/h，扬程范围为3.7~133m，按转速可分为普通转速型（转速2900r/min）和降速型（转速1450r/min），按叶轮的切割型式可分为O型、A型及B型，其中O型为原型叶轮，A型为第一次切割叶轮，B型为第二次切割叶轮。

Model IS series single-stage single suction cantilever centrifugal pump is the company strictly in accordance with ISO2858 international standards and the latest national standard GB/T5767 the successful design of a new generation of energy efficient products, its performance parameters is by original is type centrifugal water pump performance parameter optimization and expansion, the internal node structure and the overall appearance is the design of the advantages of integration is type centrifugal water pump and the existing horizontal pump, cantilever pump, the regardless of performance parameters and internal structure and the overall appearance are tends to be more reasonable and reliable.

The series contains international standard ISO2858 all types of products, and to increase the inlet diameter more than 250 (contains 250 caliber) types of products, by cutting impeller and to adjust the rotation speed can be obtained 170 kinds of products to meet the water needs of all walks of life.

This series of pumps can be used to transport water or similar physical and chemical properties of water and liquid containing solid particles with. This series of pumps can be according to the actual needs of the derived design and manufacture of ISR type hot water pump and isy type oil pump; pump model is is applicable in the medium temperature is 80℃ below, ISR type pump application in medium temperature of 100 ℃ below, ISY type pump is used for transportation of gasoline, diesel oil and light oil.

The series pump flow range is 3.4 ~ 1440m<sup>3</sup>/h, range of head to 3.7 ~ 133m. Can be divided by the speed of normal speed (speed 2900r/min) and decreasing speed type (1450r/min), according to the impeller cutting pattern can be divided into type O, type A and type B, the o type impeller prototype. Type A is the one time cutting impeller, B for the second cutting impeller.

## 结构特点 Structure characteristics

1、为单级单吸悬臂卧式结构，包含泵组件、悬架组件、电机和底座四大组件，泵组件主要包含泵体、泵盖、叶轮等零件，悬架组件主要包含轴承悬架、轴、轴承支架、轴承、轴承压盖等零件。

1. For the single stage single suction horizontal cantilever structure and consists of four major components such as pumps, suspension components, motor and base components and pump assembly consists of pump body, a pump cover, impeller and other parts, suspension assembly includes suspension bearing, a shaft, a bearing support, a bearing, a bearing gland, etc. parts.



2、为后开门结构，其优点是检修方便，检修时可以不拆泵体、吸入管路及排出管路，甚至于在机组配置加长联轴器时可以不拆电动机而只拆下加长联轴器的中间连接器即可退出转子部分进行检修。

3、泵体和泵盖构成泵的工作室，泵体有支脚支撑。叶轮、轴和轴承等组成泵的转子。轴承悬架与轴承支架联结在一起承载转子部件。

4、为平衡泵的轴向力，大多数泵的叶轮设有后密封环，与叶轮后盖板上的平衡孔配合平衡轴向力，另一方面也可以降低密封腔的压力以利于密封能达到更好的效果。

5、泵的轴封型式采用机械密封型式。轴采用20Cr13材质，既防腐蚀又耐磨。

6、为滚动轴承结构，滚动轴承承受泵的径向力和轴向力，轴承的润滑55及以下悬架采用脂润滑，55以上悬架采用油润滑。

7、传动方式为弹性柱销联轴器传动，也可采用带有中间联轴器的加长弹性柱销联轴器、膜片联轴器。

8、从电机风扇端看，泵的旋转方向为顺时针方向。

### 工作条件 Working conditions

1、泵最大工作压力（最大允许进口压力+泵设计压力）<1.6MPa，订货请注明系统工作压力；

最大允许进口压力0.4MPa，

2、适应介质：清水介质应无腐蚀性液体、介质固体不溶物，其体积不超过单位体积的0.1%，粒度<0.2mm，如介质为带有细小颗粒的请在订货时说明；

3、周围环境温度不超过40℃，相对湿度不超过95%；

4、从电机端看，泵的旋转方向为顺时针方向旋转（CW）。

5、机组常规转速为2900r/min和1450r/min，当采用其它转速时须沟通、说明。

2. After the door structure. Its advantages are convenient for repair and maintenance can be real pump, suction pipe and discharge pipe, even in the unit configuration of the lengthened coupling real motor and remove only lengthened coupling intermediate connector can exit the rotor part of the inspection and repair.

3. Pump body and pump cover to form the pump's studio, pump body has support. Impeller, shaft and bearing, etc. Bearing suspension and bearing bracket are connected together to carry the rotor component.

4. To balance the pump axial force, most of the pump impeller is provided with a rear sealing ring, and back cover plate of the impeller balance hole with the balance of axial force, on the other hand can also reduce the sealing cavity pressure to seal can achieve better effect.

5. The pump shaft seal type mechanical seal. Shaft using 20Cr13 material, not only to prevent corrosion and wear.

6. For the rolling bearing structure, rolling bearing pump radial force and axial force, the lubrication of bearings 55 and the following suspension with grease lubrication, more than 55 of the suspension with oil lubrication.

7. Transmission mode for elastic pin coupling drive, can also be used with the intermediate coupling of the extension of the elastic pin coupling, diaphragm coupling.

8. From the motor fan side, the rotation direction of the pump clockwise.

1. The maximum working pressure of pump (maximum allowable inlet pressure + pump design pressure) <1.6MPa, ordering please specify the system working pressure; Maximum allowable inlet pressure 0.4MPa.

2. Adaptation medium: clear water media should be no corrosive liquid, solid media, the volume is not more than 0.1% of the unit volume, particle size, 0.2mm, such as the medium for the small particles with the please note;

3. The ambient temperature is not more than 40℃, the relative humidity is not more than 95%;

4. From the motor side, the rotation direction of the pump clockwise rotation (CW).

5. The conventional speed of the unit is 2900r/min and 1450r/min, when the use of other speed to communicate, description.

### 型号意义 Model meaning

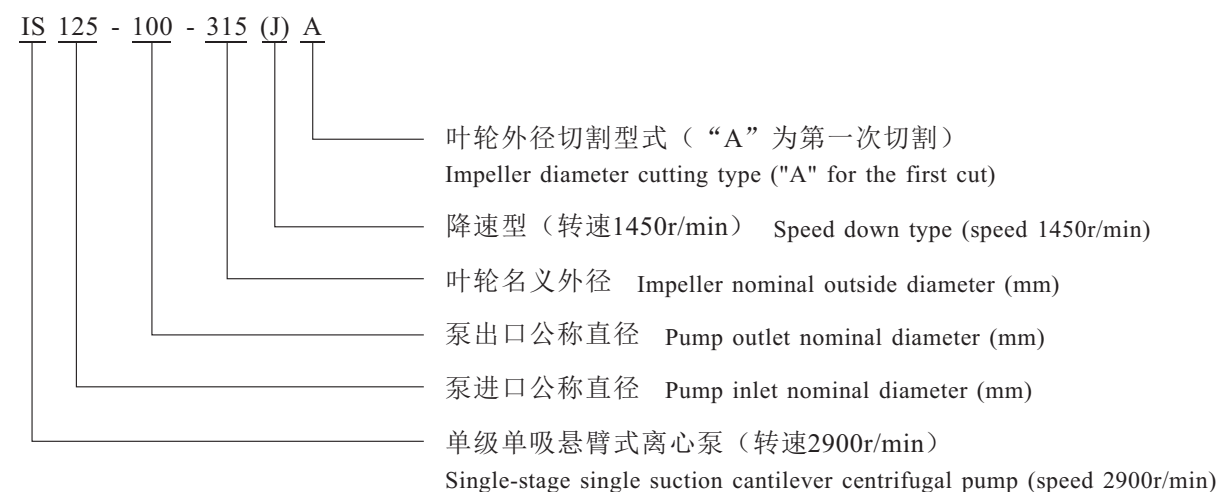

### 主要用途 Main purpose

1、常规配置泵可适用于清水或物理化学性质类似于清水的液体，适用于工业和城市给排水、水循环增压系统、消防系统、空调系统、生产工艺系统及设备配套等领域，使用温度-20℃~80℃。

2、热水泵可适用于较高温度的清水或物理化学性质类似于清水的液体，适用于锅炉系统、供暖系统、热电站、余热利用等领域，使用温度80℃~100℃。

3、不锈钢材质泵可适用于有轻度腐蚀性的液体，适用于轻纺、石油、化工、冶金、电力、造纸、食品、制药和合成纤维等部门，使用温度-20℃~100℃。

4、采用防爆电机的泵可适用于有易燃、易爆危险的液体，适用于轻纺、石油、化工、冶金、矿山等部门，使用温度-20℃~100℃。

1. The conventional pump configuration can be applied in water or the physical and chemical properties similar to liquid water apply to industrial and urban drainage, water circulation pressurization system, fire protection system, air conditioning system, production system and equipment such as field for, use temperature of - 20℃~80℃.

2. Hot water pump can be applied to a higher temperature of water or physical and chemical properties similar to the water of the liquid, suitable for boiler systems, heating systems, thermal power stations, waste heat utilization and other fields, the use of temperature 80℃~100℃.

3. Stainless steel material of pump can be applied to mildly corrosive liquid for in textile, petroleum, chemical, metallurgy, electric power, papermaking, foodstuff, pharmaceuticals, synthetic fibers, such as departments, use temperature of - 20℃~100℃.

4. The use of explosion-proof motor pump can be used in flammable and explosive liquid, suitable for textile, petroleum, chemical, metallurgy, mining and other departments, the use of temperature - 20℃~100℃.

结构说明 Structure description

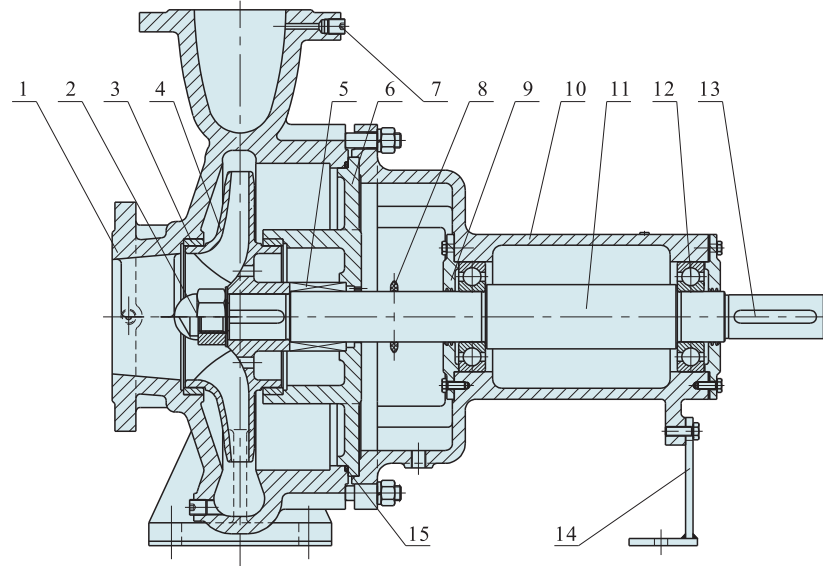

结构图1 (脂润滑结构)  
Structure figure 1 (grease lubrication structure)

序号 No.	名称 Name	常规材质 Common material
1	泵体 Pump casing	HT200
2	叶轮螺母 Impeller nut	45
3	密封环 Sealing ring	HT200
4	叶轮 Impeller	HT200
5	机械密封 Mechanical seal	碳化硅-石墨 Silicon carbide graphite
6	泵盖 Pump cover	HT200
7	丝堵 Plug	KTH300-6
8	挡水圈 The retaining ring	丁腈橡胶 Nitrile rubber
9	轴承压盖 Bearing cover	HT200
10	轴承悬架 Suspension bearing	HT200
11	轴 Shaft	20Cr13
12	滚动轴承 Rolling bearing	
13	键 Key	45
14	轴承支架 Bearing bracket	Q235-A
15	O型密封圈 O sealing ring	氟橡胶 Fluorine rubber

型谱图 Atlas of style

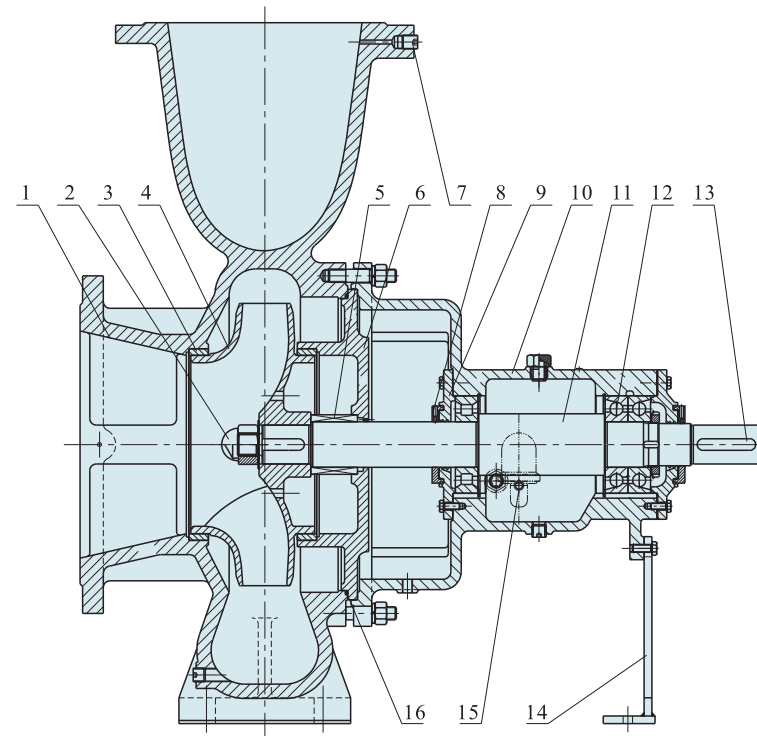
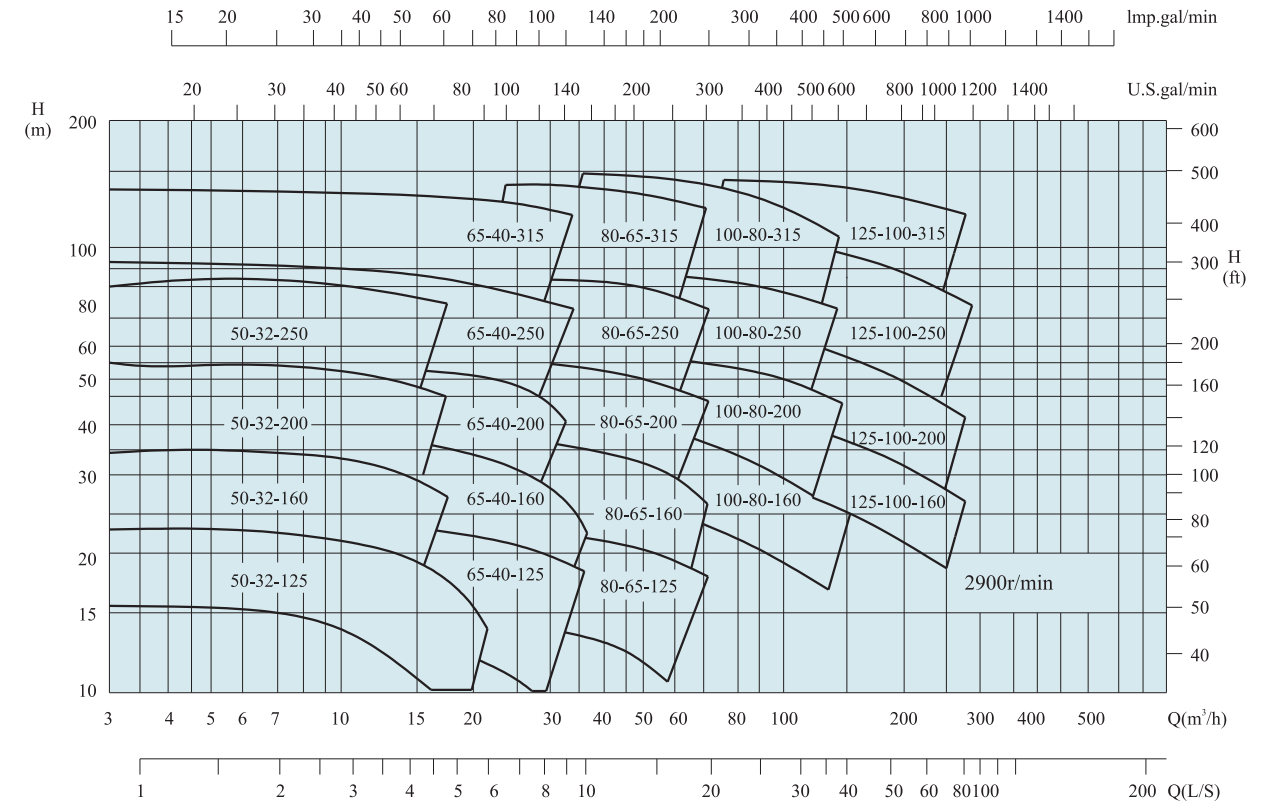

结构图2 (油润滑结构)  
Structure figure 2 (oil lubrication structure)

序号 No.	名称 Name	常规材质 Common material
1	泵体 Pump casing	HT200
2	叶轮螺母 Impeller nut	45
3	密封环 Sealing ring	HT200
4	叶轮 Impeller	HT200
5	机械密封 Mechanical seal	碳化硅-石墨 Silicon carbide graphite
6	泵盖 Pump cover	HT200
7	丝堵 Plug	KTH300-6
8	挡水圈 The retaining ring	丁腈橡胶 Nitrile rubber
9	轴承压盖 Bearing cover	HT200
10	轴承悬架 Suspension bearing	HT200
11	轴 Shaft	20Cr13
12	滚动轴承 Rolling bearing	
13	键 Key	45
14	轴承支架 Bearing bracket	Q235-A
15	油杯 Oil cup	
16	O型密封圈 O sealing ring	氟橡胶 Fluorine rubber

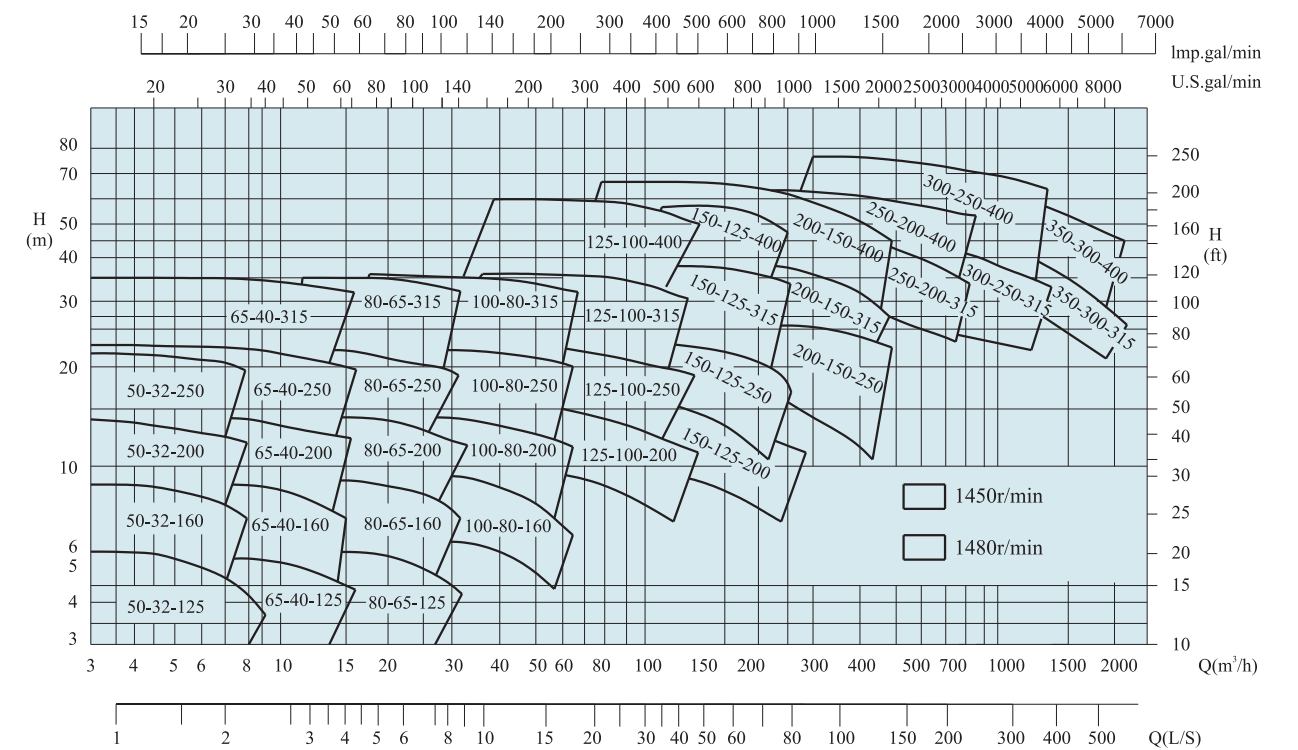



性能参数表 Performance table

型号 Model	叶轮型式 Impeller type	流量 Capacity		扬程 Head (m)	转速 Speed (r/min)	功率 Power (kW)		效率 Eff. (%)	必需汽蚀余量 (NPSH) <sub>r</sub> (m)	总质量 Total weight (kg)
		(m <sup>3</sup> /h)	(L/s)			轴功率 Shaft	电机功率 Motor power			
50-32-125	O	7.5	2.1	22.0	2900	1.0	2.2	47.0	2.0	95
		12.5	3.5	20.0		1.1		60.0	2.0	
		15.0	4.2	18.5		1.3		60.0	2.5	
	A	7.2	2.0	20.0	2900	0.9	1.5	46.0	2.0	90
		11.9	3.3	18.2		1.0		58.0	2.0	
		14.3	4.0	16.8		1.1		58.0	2.3	
	B	6.7	1.9	17.5	2900	0.7	1.1	45.0	2.0	82
		11.2	3.1	15.9		0.9		56.0	2.0	
		13.4	3.7	14.7		1.0		56.0	2.1	
50-32-160	O	7.5	2.1	34.3	2900	1.6	3	44.0	2.0	115
		12.5	3.5	32.0		2.0		54.0	2.0	
		15.0	4.2	29.6		2.2		56.0	2.5	
	A	6.8	1.9	28.4	2900	1.3	2.2	41.5	2.0	110
		11.4	3.2	26.6		1.6		52.0	2.0	
		13.7	3.8	24.6		1.7		53.0	2.2	
	B	6.1	1.7	22.5	2900	1.0	1.5	39.0	2.0	105
		10.1	2.8	21.0		1.2		50.0	2.0	
		12.2	3.4	19.4		1.3		51.0	2.0	
50-32-200	O	7.5	2.1	52.5	2900	2.8	5.5	38.0	2.0	155
		12.5	3.5	50.0		3.5		48.0	2.0	
		15.0	4.2	48.0		4.0		51.0	2.5	
	A	7.3	2.0	46.3	2900	2.6	4	37.5	2.0	145
		12.1	3.4	45.0		3.3		47.0	2.0	
		14.6	4.1	43.0		3.6		50.0	2.3	
	B	6.5	1.8	39.6	2900	2.0	3	36.0	2.0	135
		10.9	3.0	37.7		2.5		45.2	2.0	
		13.0	3.6	36.2		2.7		48.2	2.0	
50-32-250	O	7.5	2.1	82.0	2900	5.9	11	28.5	2.0	255
		12.5	3.5	80.0		7.2		38.0	2.0	
		15.0	4.2	78.5		7.8		41.0	2.5	
	A	7.0	1.9	70.6	2900	4.8	7.5	28.0	2.0	235
		11.6	3.2	68.9		5.8		37.5	2.0	
		13.9	3.9	67.6		6.4		40.0	2.3	
	B	6.5	1.8	61.2	2900	3.9	5.5	27.5	2.0	205
		10.8	3.0	59.7		4.8		36.3	2.0	
		13.0	3.6	58.6		5.3		39.0	2.1	
65-40-125	O	15.0	4.2	21.8	2900	1.5	3	58.0	2.0	115
		25.0	6.9	20.0		2.0		69.0	2.5	
		30.0	8.3	18.5		2.2		68.0	3.0	
	A	14.1	3.9	19.2	2900	1.3	2.2	55.0	2.0	110
		23.5	6.5	17.6		1.7		67.0	2.4	
		28.2	7.8	16.3		1.9		66.0	2.8	
	B	13.2	3.7	15.0	2900	0.9	1.5	50.5	2.0	105
		21.9	6.1	13.9		1.1		62.0	2.3	
		26.3	7.3	12.1		1.4		61.0	2.6	
65-40-160	O	15.0	4.2	35.0	2900	2.7	5.5	54.0	2.0	150
		25.0	6.9	32.0		3.4		65.0	2.0	
		30.0	8.3	30.0		3.7		66.0	2.5	
	A	14.1	3.9	30.8	2900	2.3	4	52.5	2.0	130
		23.5	6.5	28.2		2.9		63.0	2.0	
		28.2	7.8	26.4		3.2		64.0	2.3	

性能参数表 Performance table

型号 Model	叶轮型式 Impeller type	流量 Capacity		扬程 Head (m)	转速 Speed (r/min)	功率 Power (kW)		效率 Eff. (%)	必需汽蚀余量 (NPSH) <sub>r</sub> (m)	总质量 Total weight (kg)
		(m <sup>3</sup> /h)	(L/s)			轴功率 Shaft	电机功率 Motor power			
65-40-160	B	13.0	3.6	26.1	2900	1.9	3	49.5	2.0	110
		21.6	6.0	23.9		2.4		58.0	2.0	
		25.9	7.2	22.4		2.7		59.0	2.1	
65-40-200	O	15.0	4.2	53.0	2900	4.4	7.5	49.0	2.0	170
		25.0	6.9	50.0		5.7		60.0	2.0	
		30.0	8.3	47.0		6.3		61.0	2.5	
	A	13.5	3.8	42.9	2900	3.3	5.5	48.3	2.0	165
		22.5	6.3	40.5		4.2		59.0	2.0	
		27.0	7.5	38.1		4.7		60.0	2.1	
	B	12.8	3.6	32.8	2900	2.5	4	48.0	2.0	150
		20.0	5.6	32.0		3.0		57.5	2.0	
		25.5	7.1	30.3		3.5		59.0	2.0	
65-40-250	O	15.0	4.2	82.0	2900	9.1	15	37.0	2.0	280
		25.0	6.9	80.0		10.9		50.0	2.0	
		30.0	8.3	78.0		12.0		53.0	2.5	
	A	14.1	3.9	72.0	2900	7.6	11	36.5	2.0	270
		23.4	6.5	70.2		9.1		49.0	2.0	
		28.1	7.8	68.5		10.0		52.4	2.3	
	B	12.3	3.4	57.0	2900	5.2	7.5	35.5	2.0	260
		20.5	5.7	55.7		6.5		46.3	2.0	
		24.6	6.8	53.6		7.0		49.7	2.0	
65-40-315	O	15.0	4.2	127.0	2900	18.5	30	28.0	2.5	420
		25.0	6.9	125.0		21.3		50.0	2.5	
		30.0	8.3	123.0		22.8		44.0	3.0	
	A	14.0	3.9	111.0	2900	15.0	22	28.0	2.5	365
		23.3	6.5	109.0		17.5		39.5	2.5	
		28.0	7.8	107.0		18.8		43.5	2.8	
	B	13.1	3.6	97.5	2900	12.5	18.5	28.0	2.5	350
		21.9	6.1	96.0		14.7		39.0	2.5	
		26.3	7.3	94.4		15.7		43.0	2.6	
80-65-125	O	30.0	8.3	22.5	2900	2.9	5.5	64.0	3.0	135
		50.0	13.9	20.0		3.6		75.0	3.0	
		60.0	16.7	18.0		4.0		74.0	3.5	
	A	28.2	7.8	20.0	2900	2.6	4	63.0	3.0	125
		47.0	13.1	17.7		3.3		73.0	3.0	
		56.5	15.7	16.0		3.6		72.5	3.3	
	B	26.0	7.2	17.0	2900	2.0	3	60.5	3.0	110
		43.5	12.1	15.0		2.6		69.5	3.0	
		52.0	14.4	13.6		2.8		68.5	3.1	
80-65-160	O	30.0	8.3	36.0	2900	4.8	7.5	61.0	2.5	155
		50.0	13.9	32.0		6.0		73.0	2.5	
		60.0	16.7	29.0		6.6		72.0	3.0	
	A	28.0	7.8	31.7	2900	4.1	5.5	60.0	2.5	135
		47.0	13.1	28.2		5.1		71.0	2.5	
		56.3	15.6	25.5		5.6		70.0	2.8	
	B	25.3	7.0	25.7	2900	3.2	4	59.0	2.5	120
		42.2	11.7	2.6		4.2		67.0	2.5	
		50.7	14.1	20.7		4.6		66.0	2.6	

性能参数表 Performance table

型号 Model	叶轮型式 Impeller type	流量 Capacity		扬程 Head (m)	转速 Speed (r/min)	功率 Power (kW)		效率 Eff. (%)	必需汽 蚀余量 (NPSH) <sub>r</sub> (m)	总质量 Total weight (kg)
		(m <sup>3</sup> /h)	(L/s)			轴功率 Shaft	电机功率 Motor power			
80-65-200	O	30.0	8.3	53.0	2900	7.9	15	55.0	2.5	230
		50.0	13.9	50.0		9.9		69.0		
		60.0	16.7	47.0		10.8		71.0		
	A	27.0	7.5	45.6	2900	6.4	11	54.5	2.5	220
		43.0	11.9	43.0		8.2		67.0		
		55.0	15.3	40.7		8.9		69.5		
	B	26.1	7.3	40.2	2900	5.0	11	53.5	2.5	220
		43.3	12.0	38.0		6.4		66.0		
		52.2	14.5	35.7		7.0		68.5		
80-65-250	O	30.0	8.3	84.0	2900	13.2	22	52.0	2.5	335
		50.0	13.9	80.0		17.3		63.0		
		60.0	16.7	75.0		19.2		64.0		
	A	28.3	7.9	74.9	2900	11.0	18.5	52.3	2.5	315
		47.2	13.1	71.3		14.6		62.6		
		56.6	15.7	66.8		16.1		64.0		
	B	26.6	7.4	66.2	2900	9.1	15	52.7	2.5	305
		44.4	12.3	63.1		12.3		62.2		
		53.3	14.8	59.1		13.4		64.0		
80-65-315	O	30.0	8.3	128.0	2900	25.5	37	41.0	2.5	430
		50.0	13.9	125.0		31.5		54.0		
		60.0	16.7	123.0		35.3		57.0		
	A	28.0	7.8	108.0	2900	20.7	30	41.0	2.5	410
		46.7	13.0	106.0		25.9		53.5		
		56.0	15.6	103.7		28.2		56.7		
	B	24.3	6.8	83.9	2900	13.5	22	41.0	2.5	360
		40.5	11.3	81.9		17.2		52.5		
		48.6	13.5	80.6		19.0		56.0		
100-80-160	O	60.0	16.7	36.0	2900	8.4	15	70.0	3.5	250
		100.0	27.8	32.0		11.2		78.0		
		120.0	33.3	28.0		12.2		75.0		
	A	56.0	15.6	31.5	2900	7.2	11	69.7	3.5	240
		93.0	25.8	28.0		9.6		77.5		
		112.0	31.1	24.5		10.5		74.2		
	B	50.0	13.9	25.1	2900	4.9	7.5	69.0	3.5	220
		83.5	23.2	22.3		6.5		76.0		
		100.0	27.8	19.5		7.2		73.5		
100-80-200	O	60.0	16.7	54.0	2900	13.6	22	65.0	3.0	335
		100.0	27.8	50.0		17.9		76.0		
		120.0	33.3	47.0		19.9		77.0		
	A	56.4	15.7	47.8	2900	11.3	18.5	65.0	3.0	315
		94.1	26.1	44.2		14.8		76.5		
		113.0	31.4	41.6		16.6		77.0		
	B	53.5	14.9	42.9	2900	9.6	15	65.0	3.0	305
		89.1	24.8	39.7		12.9		74.5		
		107.0	29.7	37.3		14.3		76.0		
100-80-250	O	60.0	16.7	87.0	2950	23.4	37	61.0	3.5	440
		100.0	27.8	80.0		30.3		72.0		
		120.0	33.3	74.5		33.3		73.0		
	A	56.0	15.6	75.8	2950	19.4	30	59.5	3.5	425
		93.3	25.9	69.7		25.6		69.3		
		112.0	31.1	64.9		28.1		70.5		

性能参数表 Performance table

型号 Model	叶轮型式 Impeller type	流量 Capacity		扬程 Head (m)	转速 Speed (r/min)	功率 Power (kW)		效率 Eff. (%)	必需汽 蚀余量 (NPSH) <sub>r</sub> (m)	总质量 Total weight (kg)
		(m <sup>3</sup> /h)	(L/s)			轴功率 Shaft	电机功率 Motor power			
100-80-250	B	51.6	14.3	64.0	2950	15.0	22	56.5	3.5	410
		86.0	23.9	59.0		19.2		66.1		
		103.2	28.7	55.0		21.5		67.0		
100-80-315	O	60.0	16.7	133.0	2950	39.6	75	55.0	3.0	825
		100.0	27.8	125.0		51.6		65.0		
		120.0	33.3	118.0		57.5		67.0		
	A	56.0	15.6	116.0	2950	32.1	55	55.0	3.0	685
		93.3	25.9	109.0		42.5		65.2		
		112.0	31.1	103.0		47.5		66.0		
B	52.6	14.6	102.0	2950	26.6	45	55.0	3.0	570	
	87.6	24.3	96.0		35.5		64.5			
	105.0	29.2	90.6		39.9		65.0			
125-100-160	O	105.0	29.2	42.8	2950	16.9	30	72.0	5.6	385
		174.0	48.3	38.0		22.6		80.0		
		209.0	58.1	33.3		24.6		77.0		
	A	96.0	26.7	36.0	2900	13.1	22	72.0	5.6	325
		160.0	44.4	32.0		17.5		80.0		
		192.0	53.3	28.0		19.0		77.0		
B	89.8	24.9	31.5	2900	11.0	18.5	70.0	5.6	285	
	150.0	41.7	28.0		14.7		78.0			
	180.0	50.0	24.5		16.0		75.0			
125-100-200	O	120.0	33.3	57.5	2950	28.0	45	67.0	4.5	500
		200.0	55.6	50.0		33.6		81.0		
		240.0	66.7	44.5		36.4		80.0		
	A	111.0	30.8	49.3	2950	23.1	37	64.5	4.5	435
		185.0	51.4	42.9		27.7		78.0		
		222.0	61.7	38.2		30.0		77.0		
B	103.0	28.6	42.6	2950	19.2	30	62.5	4.5	420	
	172.0	47.8	37.1		23.2		75.0			
	207.0	57.5	33.0		25.1		74.0			
125-100-250	O	120.0	33.3	87.0	2950	43.0	75	66.0	3.8	820
		200.0	55.6	80.0		55.9		78.0		
		240.0	66.7	72.0		62.8		75.0		
	A	112.0	31.1	75.8	2950	35.0	55	66.0	3.8	750
		187.0	51.9	69.7		45.3		78.2		
		224.0	62.2	62.7		52.1		73.5		
B	104.0	28.9	60.8	2950	28.4	45	66.0	3.8	675	
	172.0	47.8	59.0		36.9		78.0			
	209.0	58.1	57.0		42.5		73.0			
125-100-315	O	120.0	33.3	133.0	2950	72.1	110	60.0	5.0	1290
		200.0	55.6	125.0		90.8		75.0		
		240.0	66.7	120.0		102.0		77.0		
	A	112.0	31.1	116.0	2950	60.4	90	59.0	4.9	1100
		187.0	51.9	110.0		76.4		73.3		
		225.0	62.5	105.0		85.9		75.1		
B	104.0	28.9	100.0	2950	49.2	75	58.0	4.3	950	
	174.0	48.3	94.8		63.5		70.8			
	209.0	58.1	91.0		70.8		73.1			



性能参数表 Performance table

型号 Model	叶轮型式 Impeller type	流量 Capacity		扬程 Head (m)	转速 Speed (r/min)	功率 Power (kW)		效率 Eff. (%)	必需汽 蚀余量 (NPSH) <sub>r</sub> (m)	总质量 Total weight (kg)
		(m <sup>3</sup> /h)	(L/s)			轴功率 Shaft	电机功率 Motor power			
50-32-125(J)	O	3.8	1.1	5.4	1450	0.1	0.55	43.0	2.0	85
		6.3	1.8	5.0		0.2		54.0	2.0	
		7.5	2.1	4.6		0.2		55.0	2.5	
	A	3.6	1.0	4.9	1450	0.1	0.55	42.0	2.0	85
		6.0	1.7	4.6		0.1		52.0	2.0	
		7.2	2.0	4.2		0.2		53.0	2.3	
	B	3.4	0.9	4.3	1450	0.1	0.55	41.0	2.0	85
		5.6	1.6	4.0		0.1		50.0	2.0	
		6.7	1.9	3.7		0.1		51.0	2.1	
50-32-160(J)	O	3.8	1.1	8.5	1450	0.3	0.55	35.0	2.0	90
		6.3	1.8	8.0		0.3		48.0	2.0	
		7.5	2.1	7.5		0.3		49.0	2.5	
	A	3.4	0.9	7.1	1450	0.2	0.55	34.0	2.0	90
		5.7	1.6	6.7		0.2		45.5	2.0	
		6.8	1.9	6.2		0.3		46.0	2.2	
	B	3.0	0.8	5.6	1450	0.1	0.55	32.0	2.0	90
		5.1	1.4	5.3		0.2		42.0	2.0	
		6.1	1.7	4.9		0.2		42.5	2.0	
50-32-200(J)	O	3.8	1.1	13.1	1450	0.4	0.75	33.0	2.0	100
		6.3	1.8	12.5		0.5		42.0	2.0	
		7.5	2.1	12.0		0.6		44.0	2.5	
	A	3.6	1.0	12.3	1450	0.4	0.75	32.5	2.0	100
		6.1	1.7	11.8		0.5		41.5	2.0	
		7.3	2.0	11.3		0.5		43.2	2.3	
	B	3.5	1.0	11.3	1450	0.3	0.75	32.0	2.0	100
		5.9	1.6	10.8		0.4		40.7	2.0	
		7.0	1.9	10.4		0.5		42.5	2.2	
50-32-250(J)	O	3.8	1.1	20.5	1450	0.9	1.5	23.0	2.0	160
		6.3	1.8	20.0		1.1		32.0	2.0	
		7.5	2.1	19.5		1.1		35.0	2.5	
	A	3.5	1.0	17.7	1450	0.8	1.1	22.1	2.0	155
		5.9	1.6	17.2		0.9		31.2	2.0	
		7.0	1.9	16.8		0.9		34.2	2.3	
	B	3.2	0.9	15.3	1450	0.6	1.1	21.5	2.0	155
		5.4	1.5	14.9		0.7		30.5	2.0	
		6.5	1.8	14.6		0.8		33.5	2.1	
65-40-125(J)	O	7.5	2.1	5.4	1450	0.2	0.55	53.0	2.0	90
		12.5	3.5	5.0		0.3		64.0	2.0	
		15.0	4.2	4.7		0.3		65.0	2.5	
	A	7.0	1.9	4.7	1450	0.2	0.55	50.5	2.0	90
		11.7	3.3	4.4		0.2		61.5	2.0	
		14.1	3.9	4.1		0.3		62.0	2.3	
	B	6.6	1.8	4.1	1450	0.2	0.55	46.5	2.0	90
		11.1	3.1	3.8		0.2		57.0	2.0	
		13.2	3.7	3.6		0.2		57.5	2.2	

性能参数表 Performance table

型号 Model	叶轮型式 Impeller type	流量 Capacity		扬程 Head (m)	转速 Speed (r/min)	功率 Power (kW)		效率 Eff. (%)	必需汽 蚀余量 (NPSH) <sub>r</sub> (m)	总质量 Total weight (kg)
		(m <sup>3</sup> /h)	(L/s)			轴功率 Shaft	电机功率 Motor power			
65-40-160(J)	O	7.5	2.1	8.8	1450	0.4	0.75	50.0	2.0	96
		12.5	3.5	8.0		0.5		60.0	2.0	
		15.0	4.2	7.2		0.5		60.0	2.5	
	A	7.0	1.9	7.8	1450	0.3	0.75	47.0	2.0	96
		11.7	3.3	7.0		0.4		58.0	2.0	
		14.1	3.9	6.3		0.4		58.0	2.3	
	B	6.5	1.8	6.6	1450	0.3	0.55	45.5	2.0	92
		10.8	3.0	6.0		0.3		55.0	2.0	
		13.0	3.6	5.4		0.4		55.0	2.1	
65-40-200(J)	O	7.5	2.1	13.2	1450	0.6	1.1	43.0	2.0	120
		12.5	3.5	12.5		0.8		55.0	2.0	
		15.0	4.2	11.8		0.9		57.0	2.5	
	A	7.1	2.0	11.9	1450	0.5	1.1	43.0	2.0	120
		11.9	3.3	11.3		0.7		55.0	2.0	
		14.3	4.0	10.7		0.7		57.0	2.3	
	B	6.8	1.9	10.7	1450	0.5	1.1	43.0	2.0	120
		11.3	3.1	10.1		0.6		55.0	2.0	
		13.5	3.8	9.6		0.6		57.0	2.1	
65-40-250(J)	O	7.5	2.1	21.0	1450	1.2	2.2	35.0	2.0	180
		12.5	3.5	20.0		1.5		46.0	2.0	
		15.0	4.2	19.4		1.7		48.0	2.5	
	A	7.0	1.9	18.4	1450	1.0	1.5	35.0	2.0	170
		11.7	3.3	17.6		1.3		44.8	2.0	
		14.1	3.9	17.0		1.4		47.0	2.3	
	B	6.6	1.8	16.0	1450	0.8	1.5	34.8	2.0	170
		10.9	3.0	15.3		1.0		43.8	2.0	
		13.1	3.6	14.8		1.2		46.2	2.1	
65-40-315(J)	O	7.5	2.1	32.3	1450	2.6	4	25.0	2.5	210
		12.5	3.5	32.0		2.9		37.0	2.5	
		15.0	4.2	31.7		3.2		41.0	3.0	
	A	7.0	1.9	28.1	1450	2.2	3	25.0	2.5	205
		11.7	3.3	27.9		2.4		36.6	2.5	
		14.0	3.9	27.6		2.6		40.8	2.8	
	B	6.6	1.8	24.8	1450	1.8	3	25.0	2.5	205
		11.0	3.1	24.6		2.0		36.3	2.5	
		13.1	3.6	24.3		2.2		40.6	2.6	
80-65-125(J)	O	15.0	4.2	5.6	1450	0.4	0.75	55.0	2.5	34
		25.0	6.9	5.0		0.5		71.0	2.5	
		30.0	8.3	4.5		0.5		72.0	3.0	
	A	14.4	4.0	5.1	1450	0.4	0.75	54.5	2.5	34
		23.9	6.6	4.6		0.4		70.0	2.5	
		28.7	8.0	4.1		0.5		71.0	2.8	
	B	13.1	3.6	4.3	1450	0.3	0.55	53.0	2.5	32
		21.8	6.1	3.8		0.3		66.0	2.5	
		26.1	7.3	3.4		0.4		67.0	2.6	

性能参数表 Performance table

型号 Model	叶轮型式 Impeller type	流量 Capacity		扬程 Head (m)	转速 Speed (r/min)	功率 Power (kW)		效率 Eff. (%)	必需汽 蚀余量 (NPSH) <sub>r</sub> (m)	总质量 Total weight (kg)
		(m <sup>3</sup> /h)	(L/s)			轴功率 Shaft	电机功率 Motor power			
80-65-160(J)	O	15.0	4.2	9.0	1450	0.7	1.5	55.0	2.5	110
		25.0	6.9	8.0		0.8		69.0	2.5	
		30.0	8.3	7.2		0.9		68.0	3.0	
	A	14.1	3.9	7.9	1450	0.6	1.1	53.5	2.5	105
		23.5	6.5	7.0		0.7		66.5	2.5	
		28.2	7.8	6.3		0.7		65.5	2.8	
	B	13.0	3.6	6.7	1450	0.5	1.1	51.0	2.5	105
		21.6	6.0	6.0		0.6		63.0	2.5	
		25.9	7.2	5.4		0.6		62.0	2.6	
80-65-200(J)	O	15.0	4.2	13.2	1450	1.1	2.2	51.0	2.5	120
		25.0	6.9	12.5		1.3		65.0	2.5	
		30.0	8.3	11.8		1.4		67.0	3.0	
	A	14.0	3.9	11.5	1450	0.9	1.5	50.6	2.5	115
		23.3	6.5	10.9		1.1		63.0	2.5	
		27.9	7.8	10.2		1.2		65.0	2.7	
	B	12.8	3.6	9.6	1450	0.7	1.5	49.4	2.5	115
		21.3	5.9	9.1		0.9		61.5	2.5	
		25.6	7.1	8.6		1.0		62.5	2.5	
80-65-250(J)	O	15.0	4.2	21.0	1450	1.8	3	49.0	2.5	175
		25.0	6.9	20.0		2.3		60.0	2.5	
		30.0	8.3	18.8		2.5		61.0	3.0	
	A	14.2	3.9	18.7	1450	1.5	3	49.0	2.5	175
		23.6	6.6	17.8		2.0		58.7	2.5	
		28.3	7.9	16.8		2.2		59.7	2.8	
	B	13.3	3.7	16.6	1450	1.2	2.2	49.0	2.5	170
		22.2	6.2	15.8		1.6		58.0	2.5	
		26.6	7.4	14.8		1.8		59.5	2.6	
80-65-315(J)	O	15.0	4.2	32.5	1450	3.4	5.5	39.0	2.5	240
		25.0	6.9	32.0		4.2		52.0	2.5	
		30.0	8.3	31.5		4.6		56.0	3.0	
	A	14.0	3.9	28.3	1450	2.8	5.5	39.0	2.5	240
		23.3	6.5	27.9		3.4		52.0	2.5	
		28.0	7.8	27.4		3.8		56.0	2.7	
	B	13.1	3.6	25.0	1450	2.3	4	39.0	2.5	210
		21.9	6.1	24.6		2.9		51.4	2.5	
		26.3	7.3	24.2		3.1		55.6	2.6	
100-80-160(J)	O	30.0	8.3	9.2	1450	1.1	2.2	67.0	2.0	150
		50.0	13.9	8.0		1.5		75.0	2.5	
		60.0	16.7	6.8		1.6		71.0	3.5	
	A	32.7	9.1	8.0	1450	1.0	1.5	66.5	2.0	140
		46.8	13.0	7.0		1.2		76.0	2.3	
		56.9	15.8	5.3		1.4		70.0	2.6	
	B	26.7	7.4	7.3	1450	0.8	1.5	66.0	2.5	140
		44.5	12.4	6.3		1.1		73.3	2.3	
		53.4	14.8	5.4		1.1		69.0	2.9	

性能参数表 Performance table

型号 Model	叶轮型式 Impeller type	流量 Capacity		扬程 Head (m)	转速 Speed (r/min)	功率 Power (kW)		效率 Eff. (%)	必需汽 蚀余量 (NPSH) <sub>r</sub> (m)	总质量 Total weight (kg)
		(m <sup>3</sup> /h)	(L/s)			轴功率 Shaft	电机功率 Motor power			
100-80-200(J)	O	30.0	8.3	13.5	1450	1.8	4	60.0	2.0	180
		50.0	13.9	12.5		2.3		73.0	2.0	
		60.0	16.7	11.8		2.6		74.0	2.5	
	A	28.2	7.8	11.9	1450	1.5	3	60.0	2.0	175
		47.0	13.1	11.1		2.0		72.7	2.0	
		56.4	15.7	10.4		2.2		73.7	2.3	
	B	26.7	7.4	10.7	1450	1.3	3	60.0	2.0	175
		44.6	12.4	9.9		1.7		72.3	2.0	
		53.5	14.9	9.4		1.9		73.3	2.2	
100-80-250(J)	O	30.0	8.3	21.3	1450	3.2	5.5	55.0	2.0	230
		50.0	13.9	20.0		4.0		68.0	2.0	
		60.0	16.7	19.0		4.4		70.0	2.5	
	A	28.0	7.8	18.6	1450	2.7	4	53.0	2.0	205
		46.7	13.0	17.4		3.4		65.5	2.0	
		56.0	15.6	16.6		3.7		67.8	2.3	
	B	26.1	7.3	16.1	1450	2.3	4	51.0	2.0	205
		43.5	12.1	15.2		2.9		62.0	2.0	
		52.2	14.5	14.4		3.2		64.6	2.1	
100-80-315(J)	O	30.0	8.3	34.0	1450	5.4	11	51.0	2.0	350
		50.0	13.9	32.0		6.9		63.0	2.0	
		60.0	16.7	30.0		7.7		64.0	2.5	
	A	28.0	7.8	29.6	1450	4.4	7.5	51.0	2.0	300
		46.7	13.0	27.9		5.6		62.8	2.0	
		56.0	15.6	26.1		6.3		63.3	2.3	
	B	26.3	7.3	26.1	1450	3.7	7.5	51.0	2.0	300
		43.8	12.2	24.6		4.7		62.7	2.0	
		52.6	14.6	23.0		5.3		62.2	2.1	
125-100-160(J)	O	52.3	14.5	10.7	1450	2.2	4	69.0	2.5	175
		87.2	24.2	9.5		2.9		77.0	2.5	
		105.0	29.2	8.3		3.2		74.0	3.0	
	A	48.0	13.3	9.0	1450	1.7	3	69.0	2.5	170
		80.0	22.2	8.0		2.3		77.0	2.5	
		96.0	26.7	7.0		2.5		74.0	3.0	
	B	44.9	12.5	7.9	1450	1.4	2.2	67.0	2.5	165
		74.8	20.8	7.0		1.9		75.0	2.5	
		89.8	24.9	6.1		2.1		72.0	3.0	
125-100-200(J)	O	60.0	16.7	14.5	1450	3.8	7.5	62.0	2.5	230
		100.0	27.8	12.5		4.5		76.0	2.5	
		120.0	33.3	11.0		4.8		75.0	3.0	
	A	55.6	15.4	12.4	1450	3.1	5.5	61.0	2.5	215
		92.6	25.7	10.7		3.7		73.5	2.5	
		111.0	30.8	9.4		3.9		73.0	2.8	
	B	51.7	14.4	10.8	1450	2.6	4	58.0	2.5	205
		86.1	23.9	9.3		3.1		70.0	2.5	
		103.0	28.6	8.2		3.3		69.0	2.6	



性能参数表 Performance table

型号 Model	叶轮型式 Impeller type	流量 Capacity		扬程 Head (m)	转速 Speed (r/min)	功率 Power (kW)		效率 Eff. (%)	必需汽 蚀余量 (NPSH) <sub>r</sub> (m)	总质量 Total weight (kg)
		(m <sup>3</sup> /h)	(L/s)			轴功率 Shaft	电机功率 Motor power			
125-100-250(J)	O	60.0	16.7	21.5	1450	5.6	11	63.0	2.5	345
		100.0	27.8	20.0		7.2		76.0	2.5	
		120.0	33.3	18.5		7.8		77.0	3.0	
	A	56.0	15.6	18.7	1450	4.5	7.5	63.0	2.5	320
		93.3	25.9	17.4		5.8		76.0	2.5	
		112.0	31.1	16.1		6.4		77.0	2.7	
	B	52.2	14.5	16.3	1450	3.7	5.5	63.0	2.5	290
		87.1	24.2	15.2		4.8		75.5	2.5	
		104.0	28.9	14.0		5.2		76.8	2.5	
125-100-315(J)	O	60.0	16.7	33.5	1450	9.4	15	58.0	2.5	410
		100.0	27.8	32.0		11.9		73.0	2.5	
		120.0	33.3	30.5		13.5		74.0	3.0	
	A	55.0	15.3	28.0	1450	8.0	11	56.0	2.5	390
		91.0	25.3	27.0		10.0		71.5	2.5	
		110.0	30.6	25.7		11.3		72.5	2.8	
	B	47.0	13.1	21.0	1450	4.9	7.5	53.0	2.5	375
		79.0	21.9	20.0		6.2		67.0	2.5	
		95.0	26.4	18.0		6.9		68.0	2.5	
125-100-400	O	60.0	16.7	52.0	1450	16.1	30	53.0	2.5	700
		100.0	27.8	50.0		21.0		65.0	2.5	
		120.0	33.3	48.5		23.6		67.0	3.0	
	A	56.4	15.7	45.9	1450	13.3	22	53.0	2.5	530
		93.9	26.1	44.1		17.4		65.0	2.5	
		113.0	31.4	42.8		19.7		66.8	2.8	
	B	52.3	14.5	39.4	1450	10.6	18.5	53.0	2.5	520
		87.1	24.2	37.9		13.9		64.7	2.5	
		105.0	29.2	36.8		15.7		66.5	2.6	
150-125-200	O	120.0	33.3	14.5	1450	6.7	11	71.0	3.0	355
		200.0	55.6	12.5		8.4		83.0	3.0	
		240.0	66.7	11.0		9.3		80.0	3.5	
	A	111.0	30.8	12.2	1450	5.4	11	68.0	3.0	355
		185.0	51.4	10.7		7.0		79.0	3.0	
		222.0	61.7	9.2		7.5		76.0	3.2	
150-125-250	O	120.0	33.3	23.2	1450	10.7	18.5	71.0	3.0	435
		200.0	55.6	20.0		13.5		81.0	3.0	
		240.0	66.7	17.0		14.3		78.0	2.5	
	A	112.0	31.1	20.2	1450	9.0	15	68.5	3.0	400
		187.0	51.9	17.4		11.5		77.0	3.0	
		224.0	62.2	14.8		12.0		75.0	3.2	
B	103.0	28.6	16.9	1450	7.3	11	64.5	3.0	385	
	171.0	47.5	14.6		9.1		75.0	3.0		
	205.0	56.9	12.4		9.8		71.0	3.1		

性能参数表 Performance table

型号 Model	叶轮型式 Impeller type	流量 Capacity		扬程 Head (m)	转速 Speed (r/min)	功率 Power (kW)		效率 Eff. (%)	必需汽 蚀余量 (NPSH) <sub>r</sub> (m)	总质量 Total weight (kg)
		(m <sup>3</sup> /h)	(L/s)			轴功率 Shaft	电机功率 Motor power			
150-125-315	O	120.0	33.3	34.0	1450	15.9	30	70.0	2.5	605
		200.0	55.6	32.0		22.1		79.0	2.5	
		240.0	66.7	29.0		23.7		80.0	3.0	
	A	112.0	31.1	29.6	1450	13.0	22	69.0	2.5	525
		186.0	51.7	27.8		18.0		78.7	2.5	
		224.0	62.2	25.2		19.4		79.0	2.7	
	B	104.0	28.9	25.6	1450	10.7	18.5	68.0	2.5	515
		174.0	48.3	24.1		14.7		77.7	2.5	
		208.0	57.8	21.8		15.9		78.0	2.6	
150-125-400	O	120.0	33.3	53.0	1450	27.9	45	62.0	2.0	640
		200.0	55.6	50.0		36.3		75.0	2.8	
		240.0	66.7	46.0		40.6		74.0	3.5	
	A	112.0	31.1	46.0	1450	22.6	37	62.0	2.0	610
		186.0	51.7	42.0		29.4		74.5	2.7	
		224.0	62.2	38.0		32.9		73.0	3.2	
	B	105.0	29.2	37.0	1450	18.5	30	62.0	2.0	590
		174.0	48.3	34.0		22.4		74.0	2.5	
		209.0	58.1	30.0		27.5		72.4	3.0	
200-150-250	O	240.0	66.7	21.5	1450	23.7	37	69.0	3.0	635
		400.0	111.1	20.0		29.1		82.5	3.5	
		460.0	127.8	16.4		30.6		82.0	4.0	
	A	223.0	61.9	19.4	1450	19.5	30	67.0	3.0	625
		371.0	103.1	18.0		23.9		80.0	3.4	
		427.0	118.6	14.8		25.2		79.5	3.7	
	B	207.0	57.5	17.4	1450	16.0	22	65.4	3.0	605
		345.0	95.8	16.2		19.8		77.5	3.3	
		397.0	110.3	13.3		20.9		77.0	3.5	
200-150-315	O	240.0	66.7	37.0	1450	34.6	55	70.0	3.0	825
		400.0	111.1	32.0		42.5		82.0	3.5	
		460.0	127.8	28.5		44.6		80.0	4.0	
	A	219.0	60.8	30.9	1450	27.2	45	68.0	3.0	730
		366.0	101.7	26.7		35.0		76.2	3.4	
		420.0	116.7	23.8		36.4		75.0	3.6	
	B	198.0	55.0	25.2	1450	22.1	37	61.5	3.0	690
		330.0	91.7	21.8		28.3		69.3	3.2	
		380.0	105.6	19.4		29.1		69.0	3.4	
200-150-400	O	228.0	63.3	55.0	1450	48.6	75	74.0	3.0	1100
		380.0	105.6	50.0		67.2		81.0	3.8	
		473.0	131.4	45.0		74.2		76.0	4.5	
	A	205.0	56.9	44.5	1450	33.0	55	72.0	3.0	1050
		342.0	95.0	40.5		45.8		78.6	3.4	
		393.0	109.2	36.5		51.7		72.0	3.8	
B	189.0	52.5	38.0	1450	26.9	45	71.0	3.0	865	
	315.0	87.5	34.5		37.6		77.0	3.3		
	362.0	100.6	31.0		42.5		70.5	3.9		
250-200-315	O	380.0	105.6	41.0	1480	59.7	110	71.0	5.5	1513
		630.0	175.0	38.0		77.1		84.5		
		760.0	211.1	35.0		86.2		84.0		
	A	380.0	105.6	35.5	1480	51.7	90	71.0	5.5	1091
		630.0	175.0	32.0		65.0		84.5		
		760.0	211.1	29.0		71.4		84.0		

性能参数表 Performance table

型号 Model	叶轮型式 Impeller type	流量 Capacity		扬程 Head (m)	转速 Speed (r/min)	功率 Power (kW)		效率 Eff. (%)	必需汽 蚀余量 (NPSH) <sub>r</sub> (m)	总质量 Total weight (kg)
		(m <sup>3</sup> /h)	(L/s)			轴功率 Shaft	电机功率 Motor power			
250-200-315	B	360.0	100.0	31.6	1480	44.6	75	69.5	5.4	984
		590.0	163.9	28.5		55.2		83.0		
		720.0	200.0	25.8		61.3		82.5		
250-200-400	O	380.0	105.6	56.3	1480	82.0	160	71.0	5.5	1750
		630.0	175.0	54.5		110.6		84.5		
		760.0	211.1	51.5		129.2		82.5		
	A	380.0	105.6	52.0	1480	75.8	132	71.0	5.5	1680
		630.0	175.0	50.0		101.5		84.5		
		760.0	211.1	46.7		117.1		82.5		
B	360.0	100.0	46.8	1480	66.0	110	69.5	5.4	1570	
	600.0	166.7	45.0		88.6		83.0			
	720.0	200.0	42.0		101.6		81.0			
300-250-315	O	670.0	186.1	37.0	1480	119.8	132	73.0	6.5	1600
		960.0	266.7	32.0		158.3		86.0		
		1150.0	319.4	28.5		183.6		84.0		
	A	600.0	166.7	30.9	1480	104.9	110	71.0	6.5	1535
		860.0	238.9	26.7		138.5		84.0		
		1030.0	286.1	23.8		160.8		82.0		
	B	575.0	159.7	25.2	1480	89.2	90	70.5	6.5	1391
		820.0	227.8	21.8		116.1		83.5		
		985.0	273.6	19.4		135.6		81.0		
300-250-400	O	670.0	186.1	53.5	1480	119.8	200	73.0	7.0	1600
		960.0	266.7	50.0		158.3		86.0		
		1150.0	319.4	47.2		183.6		84.0		
	A	600.0	166.7	46.0	1480	104.9	160	71.0	7.0	1535
		860.0	238.9	44.0		138.5		84.0		
		1030.0	286.1	38.0		160.8		82.0		
	B	575.0	159.7	40.0	1480	89.2	132	70.5	7.0	1391
		820.0	227.8	38.0		116.1		83.5		
		985.0	273.6	32.0		135.6		81.0		
350-300-315	O	840.0	233.3	44.0	1480	130.3	200	77.0	7.5	1900
		1200.0	333.3	41.0		164.0		85.0		
		1440.0	400.0	38.0		168.9		82.0		
	A	770.0	213.9	37.0	1480	113.0	160	75.0	7.5	1810
		1100.0	305.6	35.0		141.2		83.0		
		1320.0	366.7	32.0		145.4		80.0		
B	700.0	194.4	34.0	1480	93.8	132	74.0	7.5	1800	
	1000.0	277.8	32.0		117.8		81.5			
	1200.0	333.3	30.0		120.1		79.0			
350-300-400	O	840.0	233.3	57.0	1480	166.7	250	75.5	8.0	2010
		1200.0	333.3	50.0		217.8		85.5		
		1440.0	400.0	43.0		237.2		82.5		
	A	770.0	213.9	47.0	1480	141.1	200	75.0	8.0	1950
		1100.0	305.6	44.0		184.3		84.5		
		1320.0	366.7	37.0		202.2		81.5		
	B	700.0	194.4	41.0	1480	116.3	160	74.0	8.0	1860
		1000.0	277.8	38.0		152.9		83.5		
		1200.0	333.3	32.0		167.7		80.5		

泵头安装尺寸图 Size of installation of pump head

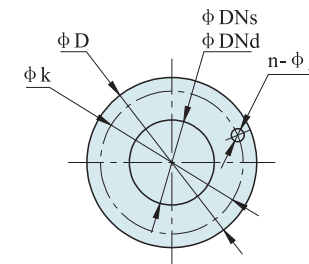
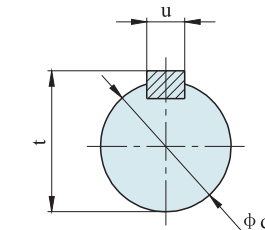
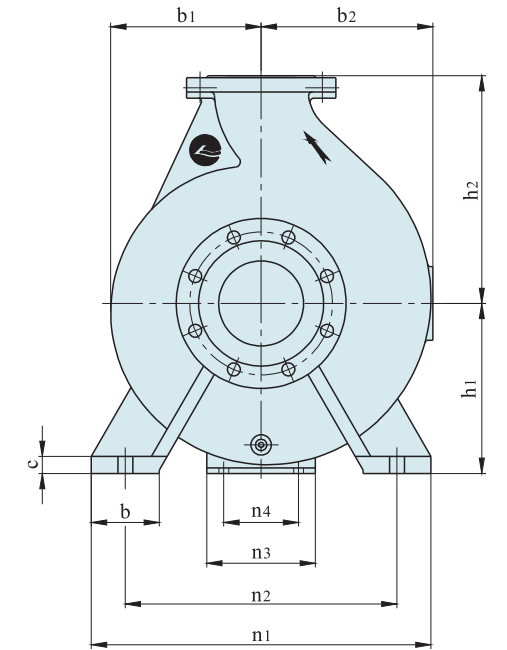
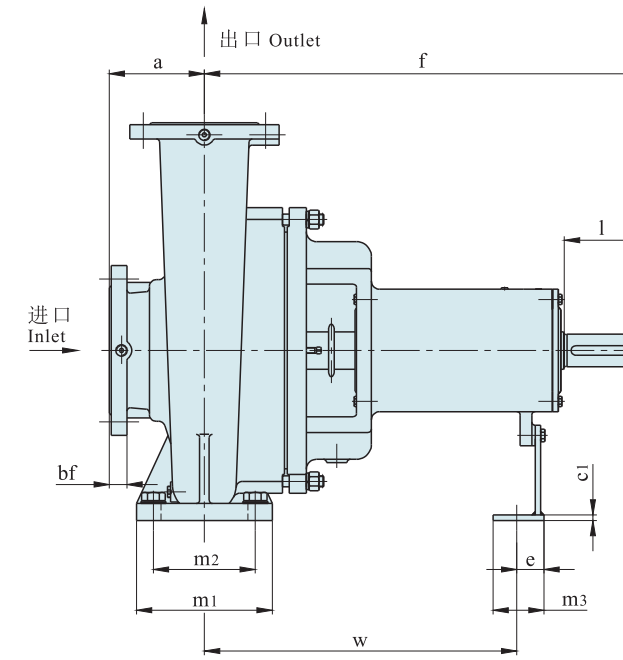

进、出口法兰  
Inlet, outlet flange

法兰尺寸 Flange size

DNs DNd	D	bf	k	g	n
32	140	18	100	18	4
40	150	18	110	18	4
50	165	20	125	18	4
65	185	20	145	18	4
80	200	22	160	18	8
100	220	22	180	18	8
125	250	26	210	18	8
150	285	26	240	22	8
200	340	26	295	22	12
250	405	28	355	26	12
300	460	28	410	26	12
350	520	30	470	26	16
400	580	32	525	30	16



泵头安装尺寸表 Table of installation of pump head

型号 Model	进口 Inlet dia. DN <sub>s</sub>	出口 Outlet dia. DN <sub>d</sub>	泵头部分尺寸 Pump head part size						底脚部分尺寸 Foot part size										配套螺栓 Mating bolt	轴键尺寸 Shaft key size					
			a	f	b <sub>1</sub>	b <sub>2</sub>	h <sub>1</sub>	h <sub>2</sub>	b	c	c <sub>1</sub>	e	m <sub>1</sub>	m <sub>2</sub>	m <sub>3</sub>	n <sub>1</sub>	n <sub>2</sub>	n <sub>3</sub>		n <sub>4</sub>	w	s	d	l	t
50-32-125	50	32	80	350	90	100	132	140	50	12	10	42	100	70	70	220	180	160	110	260	M12	24	50	27	8
50-32-160	50	32	80	350	105	117	160	170	50	12	10	42	100	70	70	220	180	160	110	260	M12	24	50	27	8
50-32-200	50	32	80	350	130	138	160	195	50	15	10	42	100	70	70	300	250	160	110	260	M12	24	50	27	8
50-32-250	50	32	110	470	142	153	180	225	50	15	10	42	100	70	70	320	250	160	110	340	M12	32	80	35	10
65-40-125	65	40	80	350	100	108	112	140	50	15	10	42	100	70	70	240	190	160	110	260	M12	24	50	27	8
65-40-160	65	40	80	350	114	134	160	170	50	15	10	42	100	70	70	240	190	160	110	260	M12	24	50	27	8
65-40-200	65	40	100	470	132	147	160	215	53	20	10	42	100	70	70	305	265	160	110	340	M12	32	80	35	10
65-40-250	65	40	110	470	151	164	180	225	65	15	10	42	100	70	70	320	250	160	110	340	M12	32	80	35	10
65-40-315	65	40	125	500	185	198	225	275	80	20	10	42	125	95	70	350	290	160	110	332	M12	42	110	45	12
80-65-125	80	65	100	350	110	140	160	190	65	15	10	42	125	95	70	280	212	160	110	260	M16	24	50	27	8
80-65-160	80	65	110	470	132	158	160	200	65	15	10	42	125	95	70	280	212	160	110	340	M16	32	80	35	10
80-65-200	80	65	110	470	144	168	180	225	65	15	10	42	125	95	70	320	250	160	110	340	M12	32	80	35	10
80-65-250	80	65	110	470	169	192	200	250	90	18	10	42	160	120	70	360	280	160	110	340	M16	32	80	35	10
80-65-315	80	65	125	500	201	221	225	280	80	25	10	42	160	120	70	400	315	160	110	332	M16	42	110	45	12
100-80-160	100	80	125	470	136	170	180	225	65	15	10	42	125	95	70	320	250	160	110	340	M12	32	80	35	10
100-80-200	100	80	125	470	161	190	200	280	65	18	10	42	125	95	70	345	280	160	110	340	M12	32	80	35	10
100-80-250	100	80	135	500	171	200	200	280	80	18	10	42	160	120	70	400	315	160	110	332	M16	42	110	45	12
100-80-315	100	80	140	500	211	235	250	315	80	25	10	42	160	120	70	400	315	160	110	332	M16	42	110	45	12
125-100-160	125	100	125	470	165	203	200	280	80	18	10	42	160	120	70	360	280	160	110	340	M16	32	80	35	10
125-100-200	125	100	140	500	171	208	200	280	80	18	10	42	160	120	70	360	280	160	110	332	M16	42	100	45	12
125-100-250	125	100	140	500	192	225	225	300	80	18	10	42	160	120	70	400	315	160	110	332	M16	42	110	45	12
125-100-315	125	100	140	640	222	253	250	335	100	25	10	42	160	120	70	400	315	160	110	460	M20	48	110	54	14
125-100-400	125	100	140	500	246	273	280	400	100	25	10	42	200	150	70	500	400	160	110	332	M20	42	110	45	12
150-125-200	150	125	140	640	220	255	250	315	100	25	10	42	200	150	70	550	450	160	110	460	M20	32	80	35	10
150-125-250	150	125	140	640	198	249	250	355	100	25	10	42	200	150	70	550	450	160	110	460	M20	48	110	54	14
150-125-315	150	125	140	500	229	269	280	355	100	30	10	42	320	230	70	730	590	280	230	332	M24	60	105	64	18
150-125-400	150	125	140	500	255	288	315	400	100	30	10	42	200	150	70	500	400	160	110	332	M20	42	110	45	12
200-150-250	200	150	160	500	228	288	280	380	100	30	10	42	200	150	70	500	400	160	110	332	M20	42	110	45	12
200-150-315	200	150	160	640	253	306	280	400	100	27	10	42	200	150	70	550	450	160	110	460	M20	48	110	54	14
200-150-400	200	150	160	640	275	320	315	450	100	27	10	42	200	150	70	550	450	160	110	460	M20	48	110	54	14
250-200-315	250	200	200	640	295	350	355	480	100	30	10	42	320	230	70	650	550	160	110	460	M24	48	110	54	14
250-200-400	250	200	200	750	315	370	390	510	100	35	12	47	320	230	80	680	580	200	150	545	M24	60	105	64	18
300-250-315	300	250	290	750	360	450	475	625	160	40	12	47	330	230	80	740	600	200	150	545	M24	60	105	64	18
300-250-400	300	250	290	750	375	460	475	625	160	40	12	47	330	230	80	740	600	200	150	545	M24	60	105	64	18
350-300-315	350	300	290	750	410	510	650	810	160	40	12	47	330	230	80	730	600	200	150	545	M24	60	105	64	18
350-300-400	350	300	285	750	349	428	430	650	150	40	12	47	320	230	80	740	590	200	150	545	M24	60	105	64	18

外形及安装尺寸图表 Out-form and installation dimension drawing, table

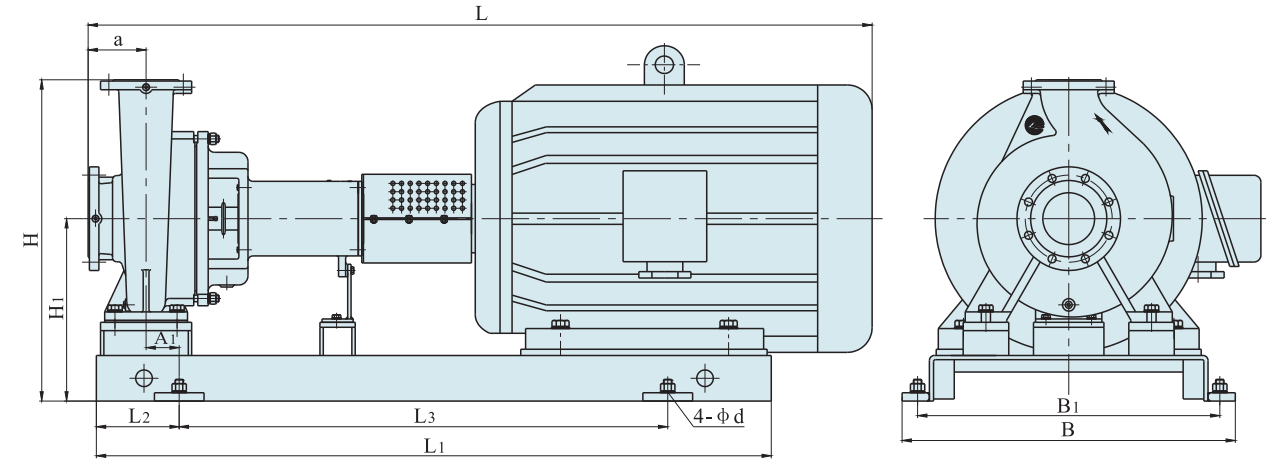

型号 Model	泵 Pump			电机 Motor		L <sub>1</sub>	L <sub>2</sub>	L <sub>3</sub>	A <sub>1</sub>	B <sub>1</sub>	H <sub>1</sub>	a	d	H	L	B
	叶轮型式 Impeller type	机座号 Frame size	kW													
50-32-125	O	90L-2	2.2	685	100	480	35	290	195	80	14	335	780	340		
	A	90S-2	1.5	660	100	480	35	290	195	80	14	335	750	340		
	B	802-2	1.1	635	100	380	35	290	195	80	14	335	730	340		
50-32-160	O	100L-2	3	715	100	480	35	290	235	80	18	405	815	340		
	A	90L-2	2.2	685	100	480	35	290	235	80	18	405	780	340		
	B	90S-2	1.5	660	100	480	35	290	235	80	18	405	750	340		
50-32-200	O	132S1-2	5.5	775	150	480	85	370	235	80	18	430	910	420		
	A	112M-2	4	725	150	480	85	370	235	80	18	430	835	420		
	B	100L-2	3	725	150	480	85	370	235	80	18	430	815	420		
50-32-250	O	160M1-2	11	1010	150	680	85	400	255	110	18	480	1190	450		
	A	132S2-2	7.5	895	150	580	85	400	255	110	18	480	1060	450		
	B	132S1-2	5.5	895	150	580	85	400	255	110	18	480	1060	450		
65-40-125	O	100L-2	3	715	100	480	35	320	195	80	18	335	815	370		
	A	90L-2	2.2	685	100	480	35	320	195	80	18	335	780	370		
	B	90S-2	1.5	660	100	480	35	320	195	80	18	335	750	370		
65-40-160	O	132S1-2	5.5	775	150	480	85	345	235	80	18	405	910	395		
	A	112M-2	4	725	150	480	85	320	235	80	18	405	835	370		
	B	100L-2	3	725	150	480	85	320	235	80	18	405	815	370		
65-40-200	O	132S2-2	7.5	895	150	580	85	400	235	100	18	450	1050	450		
	A	132S1-2	5.5	895	150	580	85	400	235	100	18	450	1050	450		
	B	112M-2	4	845	150	580	85	400	235	100	18	450	975	450		
65-40-250	O	160M2-2	15	1010	150	680	85	400	255	110	18	480	1190	450		
	A	160M1-2	11	1010	150	680	85	400	255	110	18	480	1190	450		
	B	132S2-2	7.5	895	150	580	85	400	255	110	18	480	1060	450		
65-40-315	O	200L1-1	30	1180	150	880	72.5	475	320	125	18	595	1405	530		
	A	180M-2	22	1110	150	780	72.5	445	320	125	18	595	1300	500		
	B	160L-2	18.5	1100	150	780	72.5	445	320	125	18	595	1280	500		
80-65-125	O	132S1-2	5.5	785	150	480	72.5	370	235	100	18	425	930	420		
	A	112M-2	4	740	150	480	72.5	370	235	100	18	425	855	420		
	B	100L-2	3	740	150	480	72.5	370	235	100	18	425	835	420		

外形及安装尺寸表 Out-form and installation dimension table

泵 Pump				电机 Motor										
型号 Model	叶轮型式 Impeller type	机座号 Frame size	kW	L1	L2	L3	A1	B1	H1	a	d	H	L	B
80-65-160	O	132S2-2	7.5	910	150	580	70	370	235	110	18	435	1060	420
	A	132S1-2	5.5	910	150	580	70	370	235	110	18	435	1060	420
	B	112M-2	4	860	150	580	70	370	235	110	18	435	985	420
80-65-200	O	160M2-2	15	1025	150	680	70	400	275	110	18	500	1190	450
	A	160M1-2	11	1025	150	680	70	400	275	110	18	500	1190	450
	B	160M1-2	11	1025	150	680	70	400	275	110	18	500	1190	450
80-65-250	O	180M-2	22	1095	150	780	55	475	295	110	18	545	1255	530
	A	160L-2	18.5	1095	150	780	55	475	295	110	18	545	1235	530
	B	160M2-2	15	1040	150	680	55	475	295	110	18	545	1190	530
80-65-315	O	200L2-2	37	1200	150	880	55	500	320	125	18	600	1405	555
	A	200L1-1	30	1200	150	880	55	500	320	125	18	600	1405	555
	B	180M-2	22	1125	150	780	55	500	320	125	18	600	1300	555
100-80-160	O	160M2-2	15	1025	150	680	70	400	275	125	18	500	1205	450
	A	160M1-2	11	1025	150	680	70	400	275	125	18	500	1205	450
	B	132S2-2	7.5	910	150	580	70	400	275	125	18	500	1075	450
100-80-200	O	180M-2	22	1085	150	780	65	445	295	125	18	575	1270	500
	A	160L-2	18.5	1075	150	780	65	445	295	125	18	575	1250	500
	B	160M2-2	15	1030	150	680	65	445	295	125	18	575	1205	500
100-80-250	O	200L2-2	37	1200	200	780	105	500	295	135	18	575	1415	555
	A	200L1-2	30	1200	200	780	105	500	295	135	18	575	1415	555
	B	180M-2	22	1125	200	680	105	500	295	135	18	575	1310	555
100-80-315	O	280S-2	75	1380	200	980	100	650	390	140	22	705	1645	725
	A	250M-2	55	1325	200	880	100	580	360	140	18	675	1575	635
	B	225M-2	45	1235	150	880	50	525	345	140	18	660	1460	580
125-100-160	O	200L1-1	30	1165	150	880	55	475	295	125	18	575	1375	530
	A	180M-2	22	1095	150	780	55	475	295	125	18	575	1270	530
	B	160L-2	18.5	1085	150	780	55	475	295	125	18	575	1250	530
125-100-200	O	225M-2	45	1230	150	880	55	525	320	140	18	600	1460	580
	A	200L2-2	37	1200	150	880	55	475	295	140	18	575	1420	530
	B	200L1-2	30	1200	150	880	55	475	295	140	18	575	1420	530
125-100-250	O	280S-2	75	1375	200	980	105	650	390	140	22	690	1645	725
	A	250M-2	55	1320	200	880	105	580	360	140	18	660	1575	635
	B	225M-2	45	1230	150	880	55	525	320	140	18	620	1460	580
125-100-315	O	315S-2	110	1630	200	1180	80	730	440	140	22	775	2025	805
	A	280M-2	90	1595	200	1180	80	650	390	140	22	725	1835	725
	B	280S-2	75	1540	200	1080	80	650	390	140	22	725	1785	725
50-32-125(J)	O	801-4	0.55	635	100	380	35	290	195	80	14	335	730	340
	A	801-4	0.55	635	100	380	35	290	195	80	14	335	730	340
	B	801-4	0.55	635	100	380	35	290	195	80	14	335	730	340
50-32-160(J)	O	801-4	0.55	635	100	380	35	290	235	80	18	405	730	340
	A	801-4	0.55	635	100	380	35	290	235	80	18	405	730	340
	B	801-4	0.55	635	100	380	35	290	235	80	18	405	730	340
50-32-200(J)	O	802-4	0.75	635	150	380	85	370	235	80	18	430	730	420
	A	802-4	0.75	635	150	380	85	370	235	80	18	430	730	420
	B	802-4	0.75	635	150	380	85	370	235	80	18	430	730	420
50-32-250(J)	O	90L-4	1.5	805	150	480	85	400	255	110	18	480	930	450
	A	90S-4	1.1	780	150	480	85	400	255	110	18	480	900	450
	B	90S-4	1.1	780	150	480	85	400	255	110	18	480	900	450

外形及安装尺寸表 Out-form and installation dimension table

泵 Pump				电机 Motor										
型号 Model	叶轮型式 Impeller type	机座号 Frame size	kW	L1	L2	L3	A1	B1	H1	a	d	H	L	B
65-40-125(J)	O	801-4	0.55	635	100	380	35	320	195	80	14	335	730	370
	A	801-4	0.55	635	100	380	35	320	195	80	14	335	730	370
	B	801-4	0.55	635	100	380	35	320	195	80	14	335	730	370
65-40-160(J)	O	802-4	0.75	635	150	380	85	320	235	80	18	405	730	370
	A	802-4	0.75	635	150	380	85	320	235	80	18	405	730	370
	B	801-4	0.55	635	150	380	85	320	235	80	18	405	730	370
65-40-200(J)	O	90S-4	1.1	780	150	480	85	370	235	100	18	450	890	420
	A	90S-4	1.1	780	150	480	85	370	235	100	18	450	890	420
	B	90S-4	1.1	780	150	480	85	370	235	100	18	450	890	420
65-40-250(J)	O	100L1-4	2.2	835	150	580	85	400	255	110	18	480	965	450
	A	90L-4	1.5	805	150	480	85	400	255	110	18	480	930	450
	B	90L-4	1.5	805	150	480	85	400	255	110	18	480	930	450
65-40-315(J)	O	112M-4	4	885	150	580	72.5	445	320	125	18	595	1030	520
	A	100L2-4	3	885	150	580	72.5	445	320	125	18	595	1010	520
	B	100L2-4	3	885	150	580	72.5	445	320	125	18	595	1010	520
80-65-125(J)	O	802-4	0.75	650	150	380	72.5	370	235	100	18	425	750	420
	A	802-4	0.75	650	150	380	72.5	370	235	100	18	425	750	420
	B	801-4	0.55	650	150	380	72.5	370	235	100	18	425	750	420
80-65-160(J)	O	90L-4	1.5	820	150	480	70	370	235	110	18	435	930	420
	A	90S-4	1.1	795	150	480	70	370	235	110	18	435	900	420
	B	90S-4	1.1	795	150	480	70	370	235	110	18	435	900	420
80-65-200(J)	O	100L1-4	2.2	870	150	580	65	400	275	110	18	500	965	450
	A	90L-4	1.5	825	150	480	65	400	275	110	18	500	930	450
	B	90L-4	1.5	825	150	480	65	400	275	110	18	500	930	450
80-65-250(J)	O	100L2-4	3	865	150	580	55	475	295	110	18	545	965	530
	A	100L2-4	3	865	150	580	55	475	295	110	18	545	965	530
	B	100L1-4	2.2	865	150	580	55	475	295	110	18	545	965	530
80-65-315(J)	O	132S-4	5.5	955	200	580	105	500	320	125	18	600	1105	555
	A	132S-4	5.5	955	200	580	105	500	320	125	18	600	1105	555
	B	112M-4	4	910	200	580	105	500	320	125	18	600	1030	555
100-80-160(J)	O	100L1-4	2.2	850	150	580	70	400	275	125	18	500	980	450
	A	90L-4	1.5	820	150	480	70	400	275	125	18	500	945	450
	B	90L-4	1.5	820	150	480	70	400	275	125	18	500	945	450
100-80-200(J)	O	112M-4	4	865	150	580	65	445	295	125	18	575	1000	500
	A	100L2-4	3	865	150	580	65	445	295	125	18	575	980	500
	B	100L2-4	3	865	150	580	65	445	295	125	18	575	980	500
100-80-250(J)	O	132S-4	5.5	955	200	580	105	500	295	135	18	575	1115	555
	A	112M-4	4	910	200	580	105	500	295	135	18	575	1040	555
	B	112M-4	4	910	200	580	105	500	295	135	18	575	1040	555
100-80-315(J)	O	160M-4	11	1080	200	680	100	500	345	140	18	660	1250	555
	A	132M-4	7.5	1000	200	580	100	500	345	140	18	660	1160	555
	B	132M-4	7.5	1000	200	580	100	500	345	140	18	660	1160	555
125-100-160(J)	O	112M-4	4	875	150	580	55	475	295	125	18	575	1000	530
	A	100L2-4	3	865	150	580	55	475	295	125	18	575	980	530
	B	100L1-4	2.2	865	150	580	55	475	295	125	18	575	980	530
125-100-200(J)	O	132M-4	7.5	995	150	680	55	475	295	140	18	575	1160	530
	A	132S-4	5.5	955	150	680	55	475	295	140	18	575	1120	530
	B	112M-4	4	905	150	580	55	475						

外形及安装尺寸表 Out-form and installation dimension table

泵 Pump				电机 Motor										
型号 Model	叶轮型式 Impeller type	机座号 Frame size	kW	L1	L2	L3	A1	B1	H1	a	d	H	L	B
125-100-250(J)	O	160M-4	11	1080	200	680	105	500	320	140	18	620	1250	555
	A	132M-4	7.5	990	200	580	105	500	320	140	18	620	1160	555
	B	132S-4	5.5	955	200	580	105	500	320	140	18	620	1120	555
125-100-315(J)	O	160L-4	15	1280	200	880	80	600	360	140	18	695	1435	655
	A	160M-4	11	1235	200	880	80	600	360	140	18	695	1390	655
	B	132M-4	7.5	1160	200	780	80	600	360	140	18	695	1300	655
125-100-400	O	200L-4	30	1210	200	780	100	600	390	140	18	814	1420	655
	A	180L-4	22	1180	200	780	100	600	390	140	18	814	1355	655
	B	180M-4	18.5	1130	200	780	100	600	390	140	18	814	1315	655
150-125-200	O	160M-4	11	1210	200	780	105	550	360	140	18	675	1390	605
	A	160M-4	11	1210	200	780	105	550	360	140	18	675	1390	605
150-125-250	O	180M-4	18.5	1265	200	880	105	550	360	140	18	715	1455	605
	A	160L-4	15	1255	200	880	105	550	360	140	18	715	1435	605
	B	160M-4	11	1215	200	780	105	550	360	140	18	715	1390	605
150-125-315	O	200L-4	30	1245	200	880	80	600	390	140	18	745	1420	655
	A	180L-4	22	1190	200	780	80	600	390	140	18	745	1355	655
	B	180M-4	18.5	1150	200	780	80	600	390	140	18	745	1315	655
150-125-400	O	225M-4	45	1290	200	880	80	600	425	140	18	825	1490	655
	A	225S-4	37	1255	200	880	80	600	425	140	18	825	1465	655
	B	200L-4	30	1245	200	880	80	600	425	140	18	825	1420	655
200-150-250	O	225S-4	37	1265	200	880	80	600	390	140	18	735	1465	655
	A	200L-4	30	1245	200	880	80	600	390	140	18	735	1420	655
	B	180L-4	22	1190	200	780	80	600	390	140	18	735	1355	655
200-150-315	O	250M-4	55	1485	200	1080	80	650	390	160	22	790	1735	725
	A	225M-4	45	1425	200	980	80	650	390	160	22	790	1650	725
	B	225S-4	37	1395	200	980	80	650	390	160	22	790	1625	725
200-150-400	O	280S-4	75	1545	200	1080	80	650	425	160	22	875	1805	725
	A	250M-4	55	1485	200	1080	80	650	425	160	22	875	1735	725
	B	225M-4	45	1425	200	980	80	650	425	160	22	875	1650	725
250-200-315	O	315S-4	110	1680	200	1280	60	750	480	200	22	960	2115	825
	A	280M-4	90	1615	200	1180	60	750	480	200	22	960	1895	825
	B	280S-4	75	1580	200	1180	60	750	480	200	22	960	1845	825
250-200-400	O	315L1-4	160	1900	200	1380	55	780	515	200	22	1025	2295	855
	A	315M-4	132	1900	200	1380	55	780	515	200	22	1025	2295	855
	B	315S-4	110	1800	200	1380	55	780	515	200	22	1025	2225	855
300-250-315	O	315M-4	132	1915	200	1480	45	800	515	290	22	1075	2385	875
	A	315S-4	110	1815	200	1380	45	800	515	290	22	1075	2315	875
	B	280M-4	90	1740	200	1280	45	800	515	290	22	1075	2095	875
300-250-400	O	315L2-4	200	1915	250	1380	95	815	515	290	22	1075	2385	890
	A	315L1-4	160	1915	250	1380	95	815	515	290	22	1075	2385	890
	B	315M-4	132	1915	250	1380	95	815	515	290	22	1075	2385	890
350-300-315	O	315L2-4	200	1930	250	1380	95	870	565	285	26	1215	2393	955
	A	315L1-4	160	1930	250	1380	95	870	565	285	26	1215	2393	955
	B	315M-4	132	1930	250	1380	95	870	565	285	26	1215	2393	955
350-300-400	O	355M2-4	250	2030	250	1480	95	870	565	285	26	1215	2573	955
	A	315L2-4	200	1930	250	1380	95	870	565	285	26	1215	2393	955
	B	315L1-4	160	1930	250	1380	95	870	565	285	26	1215	2393	955

管路损耗参考表 Reference table for pipeline loss

直管摩擦损失简表(供估计用)100m直管损失米数以新铸铁管为标准,旧管加倍。  
Brief table for the frictional loss of a straight pipe(for evaluation), the lost meters of a 100m straight pipe takes the newly cast iron pipe as the standard and multiple for the old one.

管径 Pipe diameter (mm)	1	2	4	6	8	10	15	20	25	30	40	50	60	70	80	90	100	110	120	130	140	160	180	200	
25	32.7	13.0																							
38	3.5	14	55																						
50	0.8	3.1	13	29																					
65		1.6	3.2	7.1	13	20																			
75		0.4	0.8	3.3	5.9	9.6	21.6																		
100			0.23	0.8	1.3	2.1	6.8	8.6	13	19.4															
125				0.23	0.4	0.63	1.3	2.7	4.1	5.9	10.7														
150					0.16	0.26	0.58	1.1	1.6	2.3	4.2	6.4	9.4												
175						0.11	0.27	0.5	0.74	1.05	1.9	2.9	4.3	5.8	7.7	9.6									
200							0.13	0.26	0.37	0.53	0.93	1.5	2.1	2.9	3.7	4.7	6.1	7.2	8.5						
250								0.07	0.12	0.18	0.30	0.48	0.68	0.93	1.2	1.5	1.9	2.3	2.8	3.3	3.7	4.9	5.2		
300									0.07	0.12	0.19	0.27	0.37	0.49	0.61	0.76	0.9	1.1	1.3	1.5	2.0	2.4	2.4	3.0	

一定管径直管之最大流量限制  
Limit of the maximum flow for a pipe with a certain diameter

管径直径 Pipeline diameter (mm)	最大流量 Maximum flow (L/s)	最大流速 Maximum flow rate (m/s)	管径直径 Pipeline diameter (mm)	最大流量 Maximum flow (L/s)	最大流速 Maximum flow rate (m/s)
25	1	2.04	125	30.0	2.44
38	2.5	1.69	150	43.0	2.45
50	4.17	2.12	175	60.0	2.49
65	6.67	2.01	200	83.3	2.69
75	10.0	2.26	250	133.0	2.72
100	18.4	2.33	300	192.0	2.71

注: 超过此限使管路损失显著增加。  
Note: The pipeline loss would be made greatly increased once the limit is over.

阀门弯管折合直管长度(每个)  
The length of a straight pipe converted into from both valve and elbow(each)

种类 Variety	折合直管直径倍数 Convert into the times of the diameter of a straight pipe	备注 Remark
全开闸阀 Fully opened gate valve	13	未畅开加倍 Multiple in case of unopen
标准弯管 Standard elbow	25	
逆止阀 Back valve	100	
底阀 Foot valve	100	部分堵塞加倍 Partial block-up multiplied

注: 例如100mm直管, 底阀折合100倍直径等于100×100=10000mm=10m, 直径长度, 假定流量为8L/s, 直管每100m损失1.3m, 则10m损失0.13m, 即一个100mm底阀, 流量为8L/s时, 则损失扬程0.13m。  
Note: For instance, a 100mm diameter pipe, the foot valve has a 100×100=10000mm=10m diameter when which is converted into 100 times that of the pipe's diameter. Suppose the flow is 8L/s, looked into the above table, the loss of the straight pipe is 1.3m each 100m, then the one for 100mm is 0.13m, that is, for a 100mm foot valve with a flow 8L/s, its head loss is 0.13m.